

SERIE 20
THERMOSTATIC
STEAM TRAPS

Thermostatic Steam Traps

Nominal diameter options (DN) 15-25
Maximum working temperature 300°C

DESCRIPTION

Thermostatic steam traps are designed for use on process equipments such as kettle cookers, sterilizers and food, chemical and laundry equipments. Connections are female screwed or flanged.



FEATURES

- Modulating discharge
- Discharges condensate close to steam temperature
- Thermostats for different sub cooling (5K to 30K)
- Excellent air discharge
- Operates on moderate superheated steam
- Built-in strainer

OPTIONS:

LC-low capacity - Integral check valve -
Blowdown valve

CONNECTIONS:

Female screwed ISO 7/1 Rp (BS21)
Flanged EN 1092-1 PN40 or ANSI

INSTALLATION:

Horizontal installation recommended

BODY LIMITING CONDITIONS		
FLANGED PN40 / ANSI 300 *	FLANGED ANSI 150 **	RELATED TEMP.
ALLOW. PRES.	ALLOW. PRES.	
40 bar	19,3 bar	50 °C
35 bar	15,8 bar	150 °C
30,4 bar	12,1 bar	250 °C
27,6 bar	10,2 bar	300 °C

PMO - Max. operating pressure 22 bar

TMO - Max. operating temperature 250 °C

* According to EN1092-1:2007 ; ** Acc. to EN1759-1:2004

Body limiting conditions PN40 or below, depending on the type of connection adopted. Rating PN40 for thread, SW and BW.

FLOW RATE CAPACITY IN Kgs/h																
MODEL	SIZE	DIFFERENTIAL PRESSURE (bar)														
		0,2	0,3	0,5	1	1,5	2	3	4	6	8	10	13	15	20	22
TH	15 - 25	70	120	140	255	330	385	455	510	600	670	700	720	750	775	795
TH with CV	15 - 25	45	55	70	95	125	135	180	200	270	315	330	360	370	405	415

Capacities shown refer to condensate at 10°C below saturated steam temperature (standard type-S thermostat) .

Thermostats for 5° C type-H and 30° type-L, also available.

Capacities for cold condensate discharge at 20°C are two to three times greater.

DIMENSIONS AND MATERIALS

DIMENSIONS (mm)											
Screwed and SW*						EN PN16/PN40		ANSI 150		ANSI 300	
SIZE DN	A	B	C	D	WGT. Kgs	E	WGT. Kgs	E	WGT. Kgs	E	WGT. Kgs
15-1/2"	95	59	95	65	1,6	150	3,2	150	2,7	150	3,5
20-3/4"	95	59	95	65	1,6	150	3,9	150	3,1	150	4,7
25-1"	95	65	95	65	1,8	160	4,7	160	4,3	160	5,9

* BW (butt weld) on request.

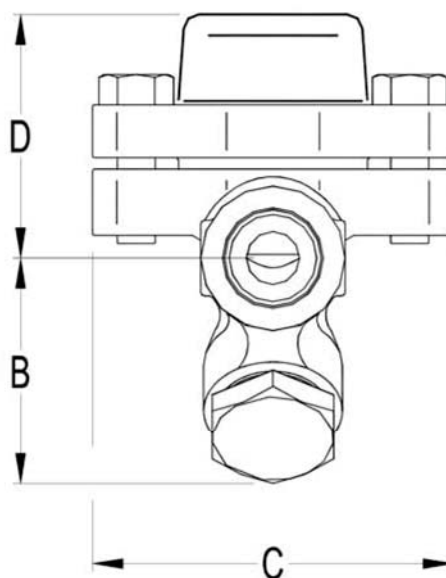
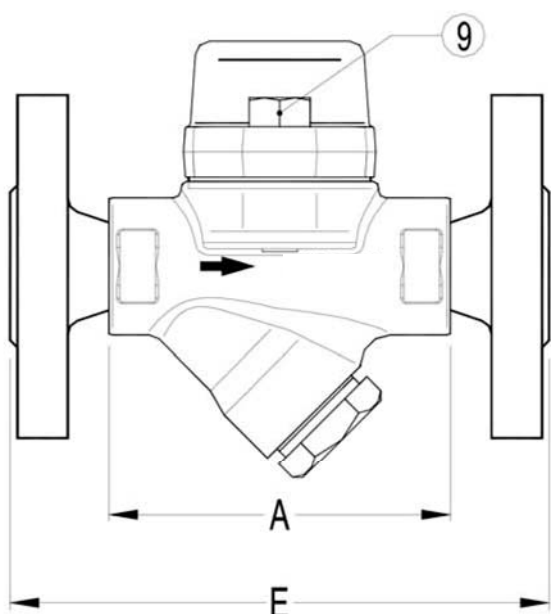

MATERIALS		
POS.N r.	DESIGNATION	MATERIAL
1	Body	P250GH / 1.0460
2	Cover	P250GH / 1.0460
3	* Gasket	St.St./Graphite
4	* Valve seat	AISI304 / 1.4301
5	* Thermostatic element	Stainless steel
6	* Strainer screen	AISI304 / 1.4301
7	* Gasket	St.Steel / Graphite
8	Cover strainer	A 105 / 1.0432
9	Bolts	A2-70

* Available spare parts

